



Leon County Property Appraiser - Parcel Details

Printed on: 11/14/2024

The Tax Roll is compiled by Legal Descriptions recorded in the Public Records of Leon County. Location addresses are not used in the preparation of the Tax Roll. They should not be used for title searches or preparation of legal documents.

Parcel Summary

| | |
|---|---|
| Parcel Number 1109204800000 | Location OLSON RD |
| Owner(s) TLH ACQUISITIONS I LLC | Property Use 0000 - VACANT RESIDENTIAL |
| Mailing Address PO BOX 13633 TALLAHASSEE FL 32317 | Legal SECTION 9 T1N R1E OR 636/666 DB 82/125 126/243 |
| Subdivision UNPLATTED LAND | Tax District 1 - CITY |
| Acreage 3.2300 | Parent Parcel |

Sales Information

| Sale Date | Sale Price | Book/Page | Instrument Type | Improved/Vacant |
|-----------|------------|-----------|-----------------|-----------------|
| 9/20/2023 | \$145,400 | 5888/2194 | Warranty Deed | Vacant |
| 2/18/1974 | \$100 | 0636/0666 | Corrective Deed | Vacant |
| | | | | |

Homestead Information

| Tax Year | Status | Details |
|----------|--------|---------|
| 2025 | No | |
| 2024 | No | |

Certified Value History

| Tax Year | Land | Building | Total Market | Homestead Savings | Classified Use |
|----------|----------|----------|--------------|-------------------|----------------|
| 2024 | \$80,750 | \$0 | \$80,750 | \$0 | \$0 |
| 2023 | \$64,600 | \$0 | \$64,600 | \$0 | \$0 |
| 2022 | \$58,140 | \$0 | \$58,140 | \$0 | \$0 |

2024 Certified Taxable Value

| Taxing Authority | Millage Rate | Market | Assessed | Exempt | Taxable |
|---|--------------|----------|----------|--------|----------|
| Leon County | 8.31440 | \$80,750 | \$80,750 | \$0 | \$80,750 |
| Leon County - Emergency Medical Service | 0.75000 | \$80,750 | \$80,750 | \$0 | \$80,750 |
| Children Services Council | 0.34770 | \$80,750 | \$80,750 | \$0 | \$80,750 |
| School - State Law | 3.13600 | \$80,750 | \$80,750 | \$0 | \$80,750 |
| School - Local Board | 2.24800 | \$80,750 | \$80,750 | \$0 | \$80,750 |
| City of Tallahassee | 4.42000 | \$80,750 | \$80,750 | \$0 | \$80,750 |
| NW FL Water Management | 0.02180 | \$80,750 | \$80,750 | \$0 | \$80,750 |
| | | | | | |

Building

| Building Use | Building Type | Year Built | Heated/Cooled SqFt | Auxiliary SqFt |
|--------------|---------------|------------|--------------------|----------------|
| | | | | |

Characteristics

| | |
|--|--|
| | |
| | |
| | |
| | |
| | |
| | |
| | |
| | |

Measurements

| Area | Description | SqFt |
|------|-------------|------|
| | | |
| | | |
| | | |
| | | |
| | | |

Sketch

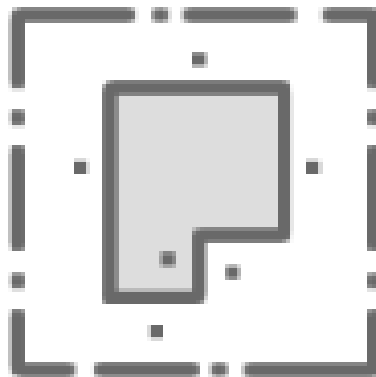

Sorry, no sketch available
for this record