



# Leon County Property Appraiser - Parcel Details

Printed on: 04/04/2025

The Tax Roll is compiled by Legal Descriptions recorded in the Public Records of Leon County. Location addresses are not used in the preparation of the Tax Roll. They should not be used for title searches or preparation of legal documents.

## Parcel Summary

Parcel Number 1123204090020	Location 1999 BUCK LAKE CIR
Owner(s) WHITTINGTON CLARK KENT WHITTINGTON DARCY LONDON	Property Use 0000 - VACANT RESIDENTIAL
Mailing Address 901 RIGGINS RD APT 632 TALLAHASSEE FL 32308	Legal SECTION 23 T1N R1E LOT 2 BOUNDARY SETTLEMENT OR 5708/1802 OR 5959/2392
Subdivision UNPLATTED LAND	Tax District 2 - COUNTY
Acreage 0.7700	Parent Parcel 1123204010000

## Sales Information

Sale Date	Sale Price	Book/Page	Instrument Type	Improved/Vacant
6/10/2024	\$220,000	5959/2392	Warranty Deed	Vacant
5/26/2022	\$100	5738/1815	Quit Claim	Vacant
5/13/2022	\$100	5734/607	Corrective Deed	Vacant

## Homestead Information

Tax Year	Status	Details
2025	No	
2024	No	

## Certified Value History

Tax Year	Land	Building	Total Market	Homestead Savings	Classified Use
2024	\$34,650	\$0	\$34,650	\$0	\$0
2023	\$36,080	\$0	\$36,080	\$0	\$0
2022	\$34,440	\$0	\$34,440	\$0	\$0

## 2024 Certified Taxable Value

Taxing Authority	Millage Rate	Market	Assessed	Exempt	Taxable
Leon County	8.31440	\$34,650	\$34,650	\$0	\$34,650
Leon County - Emergency Medical Service	0.75000	\$34,650	\$34,650	\$0	\$34,650
Children Services Council	0.34770	\$34,650	\$34,650	\$0	\$34,650
School - State Law	3.13600	\$34,650	\$34,650	\$0	\$34,650
School - Local Board	2.24800	\$34,650	\$34,650	\$0	\$34,650
NW FL Water Management	0.02180	\$34,650	\$34,650	\$0	\$34,650

## Building

Building Use	Building Type	Year Built	Heated/Cooled SqFt	Auxiliary SqFt

### Characteristics

### Measurements

Area	Description	SqFt

## Sketch

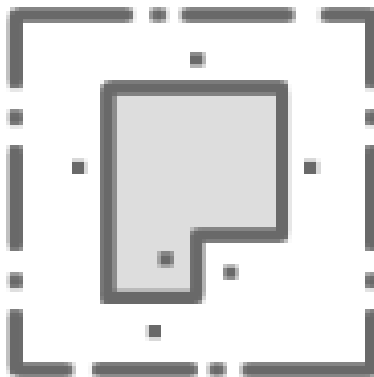

Sorry, no sketch available  
for this record