



Leon County Property Appraiser - Parcel Details

The Tax Roll is compiled by Legal Descriptions recorded in the Public Records of Leon County. Location addresses are not used in the preparation of the Tax Roll. They should not be used for title searches or preparation of legal documents.

Parcel Summary

Parcel Number 1222206180030	Location 2735 CHAIRES CROSS RD
Owner(s) ABR CONSTRUCTION INC	Property Use 6000 - GRAZING, CLASS I
Mailing Address PO BOX 15816 TALLAHASSEE FL 32317	Legal SECTION 22 T1N R2E LOT 3 LIMITED PARTITION OR 5889/2047 OR 4856/793 & 798
Subdivision UNPLATTED LAND	Tax District 2 - COUNTY
Acreage 3.0900	Parent Parcel 122220618000Z

Sales Information

Sale Date	Sale Price	Book/Page	Instrument Type	Improved/Vacant
4/30/2024	\$675,000	5950/2085	Trustee'S Deed	Vacant
9/28/2023	\$0	5889/2047	Affidavit	Vacant
9/8/2017	\$100	5109/952	Quit Claim	Vacant

Homestead Information

Tax Year	Status	Details
2025	No	
2024	No	

Certified Value History

Tax Year	Land	Building	Total Market	Homestead Savings	Classified Use
2024	\$77,250	\$0	\$77,250	\$0	\$1,082

2024 Certified Taxable Value

Taxing Authority	Millage Rate	Market	Assessed	Exempt	Taxable
Leon County	8.31440	\$77,250	\$1,082	\$0	\$1,082
Leon County - Emergency Medical Service	0.75000	\$77,250	\$1,082	\$0	\$1,082
Children Services Council	0.34770	\$77,250	\$1,082	\$0	\$1,082
School - State Law	3.13600	\$77,250	\$1,082	\$0	\$1,082
School - Local Board	2.24800	\$77,250	\$1,082	\$0	\$1,082
NW FL Water Management	0.02180	\$77,250	\$1,082	\$0	\$1,082

Building

Building Use	Building Type	Year Built	Heated/Cooled SqFt	Auxiliary SqFt

Characteristics

Measurements

Area	Description	SqFt

Sketch

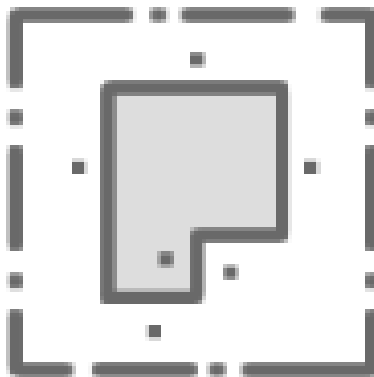

Sorry, no sketch available
for this record