



# Leon County Property Appraiser - Parcel Details

Printed on: 11/14/2024

The Tax Roll is compiled by Legal Descriptions recorded in the Public Records of Leon County. Location addresses are not used in the preparation of the Tax Roll. They should not be used for title searches or preparation of legal documents.

## Parcel Summary

Parcel Number 1227206160040	Location 0 TABB LN
Owner(s) COUTTS CHRISTOPHER JOSEPH COUTTS CHRISTIENNE	Property Use 6000 - GRAZING, CLASS I
Mailing Address 9024 TABB LN TALLAHASSEE FL 32317	Legal SECTION 27 T1N R2E NORTH LOT 4 ASAP SUBDIVISION OR 5844/1806 OR 5888/942
Subdivision UNPLATTED LAND	Tax District 2 - COUNTY
Acreage 3.0300	Parent Parcel 1227206160000

## Sales Information

Sale Date	Sale Price	Book/Page	Instrument Type	Improved/Vacant
9/27/2023	\$150,000	5888/942	Warranty Deed	Vacant
9/27/2023	\$150,000	5888/767	Warranty Deed	Vacant
5/2/2023	\$0	5844/1806	Affidavit	Vacant

## Homestead Information

Tax Year	Status	Details
2025	No	
2024	No	

## Certified Value History

Tax Year	Land	Building	Total Market	Homestead Savings	Classified Use
2024	\$75,750	\$0	\$75,750	\$0	\$4,545
2023	\$60,900	\$0	\$60,900	\$0	\$1,827
2022	\$60,900	\$0	\$60,900	\$0	\$1,827

## 2024 Certified Taxable Value

Taxing Authority	Millage Rate	Market	Assessed	Exempt	Taxable
Leon County	8.31440	\$75,750	\$4,545	\$0	\$4,545
Leon County - Emergency Medical Service	0.75000	\$75,750	\$4,545	\$0	\$4,545
Children Services Council	0.34770	\$75,750	\$4,545	\$0	\$4,545
School - State Law	3.13600	\$75,750	\$4,545	\$0	\$4,545
School - Local Board	2.24800	\$75,750	\$4,545	\$0	\$4,545
NW FL Water Management	0.02180	\$75,750	\$4,545	\$0	\$4,545

## Building

Building Use	Building Type	Year Built	Heated/Cooled SqFt	Auxiliary SqFt

### Characteristics

### Measurements

Area	Description	SqFt

## Sketch

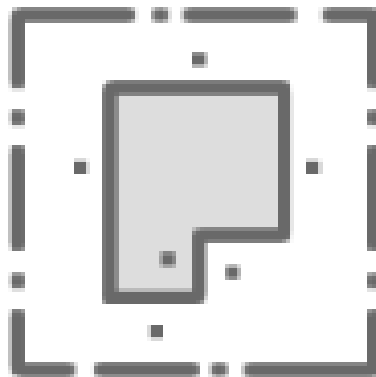

Sorry, no sketch available  
for this record