



# Leon County Property Appraiser - Parcel Details

Printed on: 04/04/2025

The Tax Roll is compiled by Legal Descriptions recorded in the Public Records of Leon County. Location addresses are not used in the preparation of the Tax Roll. They should not be used for title searches or preparation of legal documents.

## Parcel Summary

Parcel Number 1227206160050	Location 9013 TABB LN
Owner(s) DIAL ALAN B JR DIAL ANDREA D	Property Use 0000 - VACANT RESIDENTIAL
Mailing Address 9013 TABB LN TALLAHASSEE FL 32317-1600	Legal SECTION 27 T1N R2E LOT 5 219 SUBDIVISION OR 5684/806
Subdivision UNPLATTED LAND	Tax District 2 - COUNTY
Acreage 3.0900	Parent Parcel 1227206160000

## Sales Information

Sale Date	Sale Price	Book/Page	Instrument Type	Improved/Vacant
3/14/2025	\$999,000	6039/1821	Warranty Deed	Improved
12/31/2021	\$450,000	5684/806	Warranty Deed	Vacant
5/1/1999	\$340,000	2252/2221	Warranty Deed	Improved

## Homestead Information

Tax Year	Status	Details
2025	No	
2024	No	

## Certified Value History

Tax Year	Land	Building	Total Market	Homestead Savings	Classified Use
2024	\$100,000	\$0	\$100,000	\$0	\$0
2023	\$100,000	\$0	\$100,000	\$0	\$0
2022	\$30,900	\$0	\$30,900	\$0	\$0

## 2024 Certified Taxable Value

Taxing Authority	Millage Rate	Market	Assessed	Exempt	Taxable
Leon County	8.31440	\$100,000	\$37,389	\$0	\$37,389
Leon County - Emergency Medical Service	0.75000	\$100,000	\$37,389	\$0	\$37,389
Children Services Council	0.34770	\$100,000	\$37,389	\$0	\$37,389
School - State Law	3.13600	\$100,000	\$100,000	\$0	\$100,000
School - Local Board	2.24800	\$100,000	\$100,000	\$0	\$100,000
NW FL Water Management	0.02180	\$100,000	\$37,389	\$0	\$37,389

## Building

Building Use	Building Type	Year Built	Heated/Cooled SqFt	Auxiliary SqFt

### Characteristics

### Measurements

Area	Description	SqFt

## Sketch

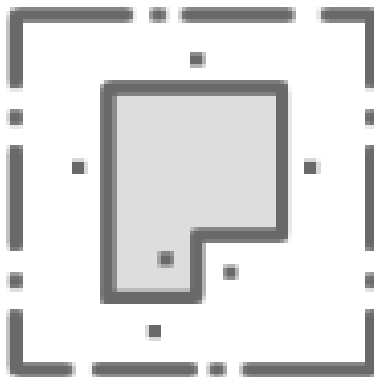

Sorry, no sketch available  
for this record