



# Leon County Property Appraiser - Parcel Details

Printed on: 11/23/2024

The Tax Roll is compiled by Legal Descriptions recorded in the Public Records of Leon County. Location addresses are not used in the preparation of the Tax Roll. They should not be used for title searches or preparation of legal documents.

## Parcel Summary

Parcel Number 1308206550000	Location 0 JO ANNE LN
Owner(s) PEREZ ROSENDO PEREZ	Property Use 0700 - MISCELLANEOUS RESIDENTIAL
Mailing Address 6517 WOODVILLE HWY TALLAHASSEE FL 32305	Legal 8 1N 3E IN W 1/2 OF SE 1/4 OF SW 1/4 OR 902/1769 1905/443 2195/262 265 LOT 5 OF 2.1.9 SUB
Subdivision UNPLATTED LAND	Tax District 2 - COUNTY
Acreage 1.3500	Parent Parcel 1308206070000

## Sales Information

Sale Date	Sale Price	Book/Page	Instrument Type	Improved/Vacant
11/22/2023	\$57,000	5908/2000	Warranty Deed	Improved
8/23/2023	\$100	5880/87	Warranty Deed	Improved
7/11/2023	\$33,400	5865/143	Cert Of Title	Improved

## Homestead Information

Tax Year	Status	Details
2025	No	
2024	No	

## Certified Value History

Tax Year	Land	Building	Total Market	Homestead Savings	Classified Use
2024	\$20,250	\$1,240	\$21,490	\$0	\$0
2023	\$16,200	\$1,240	\$17,440	\$0	\$0
2022	\$16,200	\$1,240	\$17,440	\$0	\$0

## 2024 Certified Taxable Value

Taxing Authority	Millage Rate	Market	Assessed	Exempt	Taxable
Leon County	8.31440	\$21,490	\$21,490	\$0	\$21,490
Leon County - Emergency Medical Service	0.75000	\$21,490	\$21,490	\$0	\$21,490
Children Services Council	0.34770	\$21,490	\$21,490	\$0	\$21,490
School - State Law	3.13600	\$21,490	\$21,490	\$0	\$21,490
School - Local Board	2.24800	\$21,490	\$21,490	\$0	\$21,490
NW FL Water Management	0.02180	\$21,490	\$21,490	\$0	\$21,490

## Building

Building Use	Building Type	Year Built	Heated/Cooled SqFt	Auxiliary SqFt

### Characteristics



### Measurements

Area	Description	SqFt

## Sketch

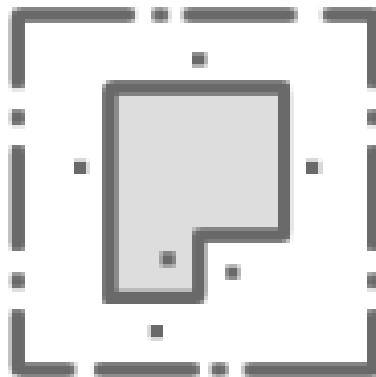

Sorry, no sketch available  
for this record