



Leon County Property Appraiser - Parcel Details

Printed on: 11/23/2024

The Tax Roll is compiled by Legal Descriptions recorded in the Public Records of Leon County. Location addresses are not used in the preparation of the Tax Roll. They should not be used for title searches or preparation of legal documents.

Parcel Summary

Parcel Number 1409206030000	Location 0 BANNERMAN RD
Owner(s) KETCHEL ANDREW KETCHEL MCKENZIE	Property Use 0000 - VACANT RESIDENTIAL
Mailing Address 1990 BANNERMAN RD TALLAHASSEE FL 32312	Legal 9 2N 1E IN NW 1/4 OF SW 1/4 OR 988/169 996/962
Subdivision UNPLATTED LAND	Tax District 2 - COUNTY
Acreage 1.1600	Parent Parcel

Sales Information

Sale Date	Sale Price	Book/Page	Instrument Type	Improved/Vacant
8/8/2023	\$115,000	5875/681	Warranty Deed	Vacant
8/8/2023	\$95,000	5875/632	Warranty Deed	Vacant
6/17/2019	\$0	5551/1414	Quit Claim	Vacant

Homestead Information

Tax Year	Status	Details
2025	No	
2024	No	

Certified Value History

Tax Year	Land	Building	Total Market	Homestead Savings	Classified Use
2024	\$75,000	\$0	\$75,000	\$0	\$0
2023	\$75,000	\$0	\$75,000	\$0	\$0
2022	\$75,000	\$0	\$75,000	\$0	\$0

2024 Certified Taxable Value

Taxing Authority	Millage Rate	Market	Assessed	Exempt	Taxable
Leon County	8.31440	\$75,000	\$75,000	\$0	\$75,000
Leon County - Emergency Medical Service	0.75000	\$75,000	\$75,000	\$0	\$75,000
Children Services Council	0.34770	\$75,000	\$75,000	\$0	\$75,000
School - State Law	3.13600	\$75,000	\$75,000	\$0	\$75,000
School - Local Board	2.24800	\$75,000	\$75,000	\$0	\$75,000
NW FL Water Management	0.02180	\$75,000	\$75,000	\$0	\$75,000

Building

Building Use	Building Type	Year Built	Heated/Cooled SqFt	Auxiliary SqFt

Characteristics

Measurements

Area	Description	SqFt

Sketch

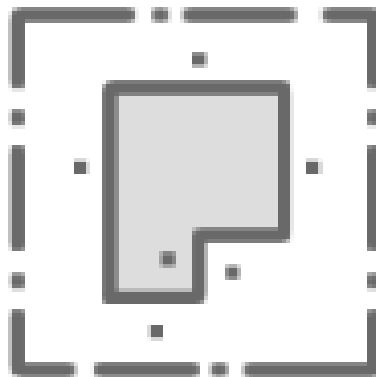

Sorry, no sketch available
for this record