



Leon County Property Appraiser - Parcel Details

Printed on: 11/24/2024

The Tax Roll is compiled by Legal Descriptions recorded in the Public Records of Leon County. Location addresses are not used in the preparation of the Tax Roll. They should not be used for title searches or preparation of legal documents.

Parcel Summary

| | |
|--|---|
| Parcel Number 1428204010000 | Location 2570 COLD HARBOR DR |
| Owner(s) MEADOWS TLH COMMERCIAL LLC | Property Use 9900 - VACANT ACREAGE, NOT AGR |
| Mailing Address 4708 CAPITAL CIR NW TALLAHASSEE FL 32303 | Legal SECTION 28 T2N R1E PART OF TRACT 2 TECHNICAL AMENDMENT OR 3168/1957 OR 5880/1920 |
| Subdivision UNPLATTED LAND | Tax District 1 - CITY |
| Acreage 4.1400 | Parent Parcel |

Sales Information

| Sale Date | Sale Price | Book/Page | Instrument Type | Improved/Vacant |
|-----------|-------------|-----------|-----------------|-----------------|
| 8/29/2023 | \$2,800,000 | 5880/1920 | Warranty Deed | Vacant |
| 8/8/2014 | \$600 | 4699/427 | Cert Of Title | Improved |
| 7/9/2012 | \$283,000 | 4527/1655 | Quit Claim | Improved |

Homestead Information

| Tax Year | Status | Details |
|----------|--------|---------|
| 2025 | No | |
| 2024 | No | |

Certified Value History

| Tax Year | Land | Building | Total Market | Homestead Savings | Classified Use |
|----------|-----------|----------|--------------|-------------------|----------------|
| 2024 | \$993,600 | \$0 | \$993,600 | \$0 | \$0 |
| 2023 | \$993,600 | \$0 | \$993,600 | \$0 | \$0 |
| 2022 | \$910,800 | \$0 | \$910,800 | \$0 | \$0 |

2024 Certified Taxable Value

| Taxing Authority | Millage Rate | Market | Assessed | Exempt | Taxable |
|---|--------------|-----------|-----------|--------|-----------|
| Leon County | 8.31440 | \$993,600 | \$993,600 | \$0 | \$993,600 |
| Leon County - Emergency Medical Service | 0.75000 | \$993,600 | \$993,600 | \$0 | \$993,600 |
| Children Services Council | 0.34770 | \$993,600 | \$993,600 | \$0 | \$993,600 |
| School - State Law | 3.13600 | \$993,600 | \$993,600 | \$0 | \$993,600 |
| School - Local Board | 2.24800 | \$993,600 | \$993,600 | \$0 | \$993,600 |
| City of Tallahassee | 4.42000 | \$993,600 | \$993,600 | \$0 | \$993,600 |
| NW FL Water Management | 0.02180 | \$993,600 | \$993,600 | \$0 | \$993,600 |
| | | | | | |

Building

| Building Use | Building Type | Year Built | Heated/Cooled SqFt | Auxiliary SqFt |
|--------------|---------------|------------|--------------------|----------------|
| | | | | |

Characteristics

| | |
|--|--|
| | |
| | |
| | |
| | |
| | |
| | |
| | |
| | |

Measurements

| Area | Description | SqFt |
|------|-------------|------|
| | | |
| | | |
| | | |
| | | |
| | | |

Sketch

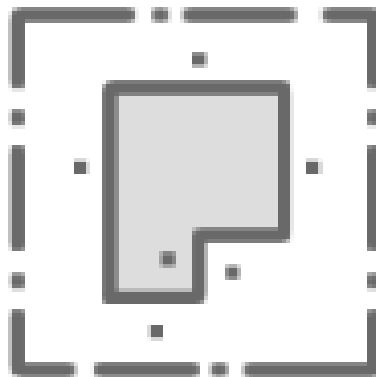

Sorry, no sketch available
for this record