



# Leon County Property Appraiser - Parcel Details

Printed on: 10/22/2024

## Parcel Summary

Parcel Number 1511202040000	Location 0 LEE REEVES RD
Owner(s) WOODFIELD SPRINGS PLANTATION INC	Property Use 9900 - VACANT ACREAGE, NOT AGRI
Mailing Address 1422 EUCLID AVE STE 1150 CLEVELAND OH 44115	Legal 11 2N 2E 20 A IN W 1/2 OF NW 1/4 OF NW 1/4 OR 355/102 (WOODFIELD SPRINGS PLANTATION)
Subdivision UNPLATTED LAND	Tax District 2 - COUNTY
Acreage 20.0000	Parent Parcel

## Sales Information

Sales Date	Sales Price	Book/Page	Instrument Type	Improved/Vacant
9/20/2024	\$9,176,000	5992/1006	Trustee'S Deed	Vacant
4/22/2009	\$100	3982/1052	Warranty Deed	Vacant

## Homestead Information

Tax Year	Status	Details
2025	No	
2024	No	

## Certified Value History

Tax Year	Land	Building	Total Market	Homestead Savings	Classified Use
2024	\$250,000	\$0	\$250,000	\$0	\$0
2023	\$250,000	\$0	\$250,000	\$0	\$0
2022	\$250,000	\$0	\$250,000	\$0	\$0

## Certified Taxable Value

Taxing Authority	Milage Rate	Market	Assessed	Exempt	Taxable
Leon County	8.31440	\$250,000	\$250,000	\$250,000	\$0
Leon County - Emergency Medical Service	0.75000	\$250,000	\$250,000	\$250,000	\$0
Children Services Council	0.34770	\$250,000	\$250,000	\$250,000	\$0
School - State Law	3.13600	\$250,000	\$250,000	\$250,000	\$0
School - Local Board	2.24800	\$250,000	\$250,000	\$250,000	\$0
NW FL Water Management	0.02180	\$250,000	\$250,000	\$250,000	\$0

## Building

Building Use	Building Type	Year Built	Heated/Cooled SqFt	Auxiliary SqFt

### Characteristics

### Measurements

Area	Description	SqFT

## Sketch

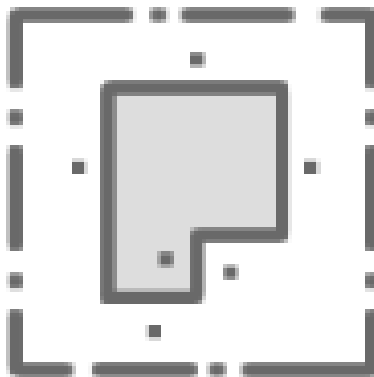

Sorry, no sketch available  
for this record