



Leon County Property Appraiser - Parcel Details

Printed on: 11/23/2024

The Tax Roll is compiled by Legal Descriptions recorded in the Public Records of Leon County. Location addresses are not used in the preparation of the Tax Roll. They should not be used for title searches or preparation of legal documents.

Parcel Summary

Parcel Number 1608206040000	Location 8807 SPRING HOLLOW LN
Owner(s) DAVIS INVESTMENT HOLDINGS LLC	Property Use 0000 - VACANT RESIDENTIAL
Mailing Address 7773 CORNUCOPIA LN TALLAHASSEE FL 32309	Legal SECTION 8 T2N R3E OR 827/421 844/411
Subdivision UNPLATTED LAND	Tax District 2 - COUNTY
Acreage 1.6500	Parent Parcel

Sales Information

Sale Date	Sale Price	Book/Page	Instrument Type	Improved/Vacant
10/18/2023	\$17,500	5899/290	County Deed (FI St 125.411)	Vacant
10/21/2019	\$0	5372/1732	Tax Deed	Vacant
2/28/2012	\$4,800	4373/1769	Tax Deed	Improved

Homestead Information

Tax Year	Status	Details
2025	No	
2024	No	

Certified Value History

Tax Year	Land	Building	Total Market	Homestead Savings	Classified Use
2024	\$19,800	\$0	\$19,800	\$0	\$0
2023	\$16,500	\$0	\$16,500	\$0	\$0
2022	\$16,500	\$0	\$16,500	\$0	\$0

2024 Certified Taxable Value

Taxing Authority	Millage Rate	Market	Assessed	Exempt	Taxable
Leon County	8.31440	\$19,800	\$19,800	\$0	\$19,800
Leon County - Emergency Medical Service	0.75000	\$19,800	\$19,800	\$0	\$19,800
Children Services Council	0.34770	\$19,800	\$19,800	\$0	\$19,800
School - State Law	3.13600	\$19,800	\$19,800	\$0	\$19,800
School - Local Board	2.24800	\$19,800	\$19,800	\$0	\$19,800
NW FL Water Management	0.02180	\$19,800	\$19,800	\$0	\$19,800

Building

Building Use	Building Type	Year Built	Heated/Cooled SqFt	Auxiliary SqFt

Characteristics

Measurements

Area	Description	SqFt

Sketch

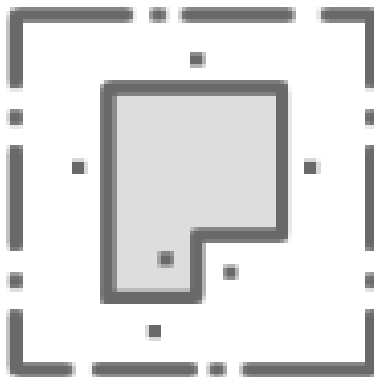

Sorry, no sketch available
for this record