



Leon County Property Appraiser - Parcel Details

Printed on: 11/23/2024

The Tax Roll is compiled by Legal Descriptions recorded in the Public Records of Leon County. Location addresses are not used in the preparation of the Tax Roll. They should not be used for title searches or preparation of legal documents.

Parcel Summary

Parcel Number 1619200080000	Location 0 WILEY RD
Owner(s) PERRY JEFFREY CADY	Property Use 5400 - TIMBERLAND, INDEX 90+
Mailing Address 9230 OAKFAIR DR TALLAHASSEE FL 32317	Legal SECTION 19 T2N R3E OR 294/278
Subdivision UNPLATTED LAND	Tax District 2 - COUNTY
Acreage 10.0700	Parent Parcel

Sales Information

Sale Date	Sale Price	Book/Page	Instrument Type	Improved/Vacant
3/1/2024	\$100,000	5930/389	Estate Deed	Vacant
4/16/2014	\$0	5123/607	Probate	Vacant
4/16/2014	\$0	4835/603	Probate	Vacant

Homestead Information

Tax Year	Status	Details
2025	No	
2024	No	

Certified Value History

Tax Year	Land	Building	Total Market	Homestead Savings	Classified Use
2024	\$100,700	\$0	\$100,700	\$0	\$5,428
2023	\$100,000	\$0	\$100,000	\$0	\$4,860
2022	\$100,000	\$0	\$100,000	\$0	\$4,860

2024 Certified Taxable Value

Taxing Authority	Millage Rate	Market	Assessed	Exempt	Taxable
Leon County	8.31440	\$100,700	\$5,428	\$0	\$5,428
Leon County - Emergency Medical Service	0.75000	\$100,700	\$5,428	\$0	\$5,428
Children Services Council	0.34770	\$100,700	\$5,428	\$0	\$5,428
School - State Law	3.13600	\$100,700	\$5,428	\$0	\$5,428
School - Local Board	2.24800	\$100,700	\$5,428	\$0	\$5,428
NW FL Water Management	0.02180	\$100,700	\$5,428	\$0	\$5,428

Building

Building Use	Building Type	Year Built	Heated/Cooled SqFt	Auxiliary SqFt

Characteristics

Measurements

Area	Description	SqFt

Sketch

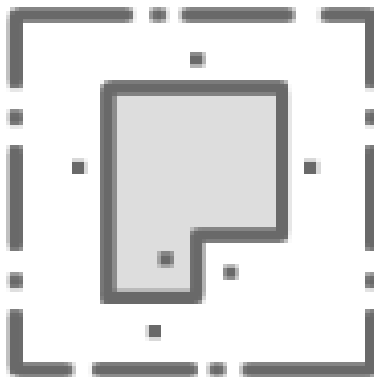

Sorry, no sketch available
for this record