



# Leon County Property Appraiser - Parcel Details

Printed on: 11/14/2024

The Tax Roll is compiled by Legal Descriptions recorded in the Public Records of Leon County. Location addresses are not used in the preparation of the Tax Roll. They should not be used for title searches or preparation of legal documents.

## Parcel Summary

Parcel Number 1632200080000	Location 0 VETERANS MEMORIAL DR
Owner(s) CALVERT CHRISTOPHER CALVERT LISA M	Property Use 9900 - VACANT ACREAGE, NOT AGR
Mailing Address 77 CARDINAL FARM WAY MONTICELLO FL 32344	Legal SECTION 32 T2N R3E OR 3889/816 (2ND DESC)
Subdivision UNPLATTED LAND	Tax District 2 - COUNTY
Acreage 13.1300	Parent Parcel

## Sales Information

Sale Date	Sale Price	Book/Page	Instrument Type	Improved/Vacant
11/15/2023	\$200,000	5903/110	Warranty Deed	Vacant
9/13/2023	\$142,000	5884/2372	Warranty Deed	Vacant
7/18/2023	\$0	5868/502	Final Judgement	Vacant

## Homestead Information

Tax Year	Status	Details
2025	No	
2024	No	

## Certified Value History

Tax Year	Land	Building	Total Market	Homestead Savings	Classified Use
2024	\$157,560	\$0	\$157,560	\$0	\$0
2023	\$131,300	\$0	\$131,300	\$0	\$0
2022	\$91,910	\$0	\$91,910	\$0	\$0

## 2024 Certified Taxable Value

Taxing Authority	Millage Rate	Market	Assessed	Exempt	Taxable
Leon County	8.31440	\$157,560	\$157,560	\$0	\$157,560
Leon County - Emergency Medical Service	0.75000	\$157,560	\$157,560	\$0	\$157,560
Children Services Council	0.34770	\$157,560	\$157,560	\$0	\$157,560
School - State Law	3.13600	\$157,560	\$157,560	\$0	\$157,560
School - Local Board	2.24800	\$157,560	\$157,560	\$0	\$157,560
NW FL Water Management	0.02180	\$157,560	\$157,560	\$0	\$157,560

## Building

Building Use	Building Type	Year Built	Heated/Cooled SqFt	Auxiliary SqFt

### Characteristics

### Measurements

Area	Description	SqFt

## Sketch

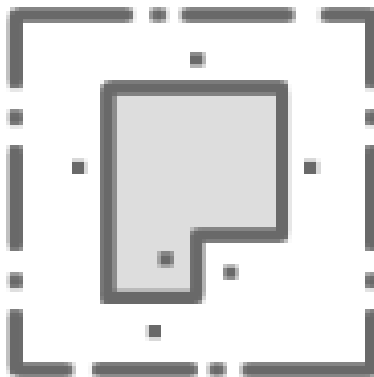

Sorry, no sketch available  
for this record