



Leon County Property Appraiser - Parcel Details

Printed on: 11/23/2024

The Tax Roll is compiled by Legal Descriptions recorded in the Public Records of Leon County. Location addresses are not used in the preparation of the Tax Roll. They should not be used for title searches or preparation of legal documents.

Parcel Summary

Parcel Number 1707202610000	Location 0 N MERIDIAN RD
Owner(s) OLD MERIDIAN PLANTATION LLC	Property Use 5400 - TIMBERLAND, INDEX 90+
Mailing Address 1538 METROPOLITAN BLVD TALLAHASSEE FL 32308	Legal 7 3N 1E PART OF FRACTIONAL LOTS 261 & 262 WEST OF MERIDIAN ROAD & N OF CREEK OR 2079/828 LYING WITHIN LEON COUNTY OR 1938/1948
Subdivision UNPLATTED LAND	Tax District 2 - COUNTY
Acreage 82.0300	Parent Parcel 1708202620000

Sales Information

Sale Date	Sale Price	Book/Page	Instrument Type	Improved/Vacant
12/20/2023	\$686,800	5911/1972	Warranty Deed	Vacant
12/31/2009	\$772,000	4072/1577	Warranty Deed	Vacant
12/30/2009	\$0	4072/1570	Corrective Deed	Vacant

Homestead Information

Tax Year	Status	Details
2025	No	
2024	No	

Certified Value History

Tax Year	Land	Building	Total Market	Homestead Savings	Classified Use
2024	\$410,150	\$0	\$410,150	\$0	\$41,824
2023	\$410,150	\$0	\$410,150	\$0	\$38,007
2022	\$410,150	\$0	\$410,150	\$0	\$38,007

2024 Certified Taxable Value

Taxing Authority	Millage Rate	Market	Assessed	Exempt	Taxable
Leon County	8.31440	\$410,150	\$41,824	\$0	\$41,824
Leon County - Emergency Medical Service	0.75000	\$410,150	\$41,824	\$0	\$41,824
Children Services Council	0.34770	\$410,150	\$41,824	\$0	\$41,824
School - State Law	3.13600	\$410,150	\$41,824	\$0	\$41,824
School - Local Board	2.24800	\$410,150	\$41,824	\$0	\$41,824
NW FL Water Management	0.02180	\$410,150	\$41,824	\$0	\$41,824

Building

Building Use	Building Type	Year Built	Heated/Cooled SqFt	Auxiliary SqFt

Characteristics

Measurements

Area	Description	SqFt

Sketch

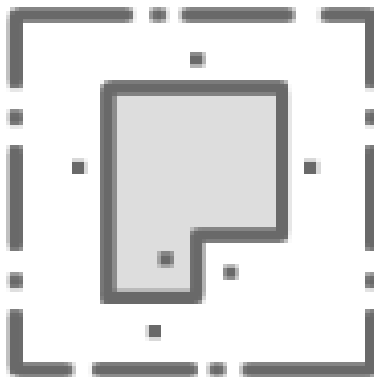

Sorry, no sketch available
for this record