



Leon County Property Appraiser - Parcel Details

Printed on: 11/23/2024

The Tax Roll is compiled by Legal Descriptions recorded in the Public Records of Leon County. Location addresses are not used in the preparation of the Tax Roll. They should not be used for title searches or preparation of legal documents.

Parcel Summary

Parcel Number 2117206560000	Location 0 ROBINSON OAK DR
Owner(s) YANEZ ENRIQUE YANEZ MARICELA	Property Use 0000 - VACANT RESIDENTIAL
Mailing Address 4220 SHORTSWOOD ST TALLAHASSEE FL 32303-7130	Legal 17 1N 1W 4 A IN N 1/2 OF SW 1/4 OR 732/246
Subdivision UNPLATTED LAND	Tax District 2 - COUNTY
Acreage 4.0000	Parent Parcel

Sales Information

Sale Date	Sale Price	Book/Page	Instrument Type	Improved/Vacant
10/31/2024	\$100,000	6003/1188	Warranty Deed	Vacant
10/13/2006	\$160,000	3598/388	Warranty Deed	Vacant
8/28/2006	\$0	3598/384	Quit Claim	Vacant

Homestead Information

Tax Year	Status	Details
2025	No	
2024	No	

Certified Value History

Tax Year	Land	Building	Total Market	Homestead Savings	Classified Use
2024	\$80,000	\$0	\$80,000	\$0	\$0
2023	\$80,000	\$0	\$80,000	\$0	\$0
2022	\$60,000	\$0	\$60,000	\$0	\$0

2024 Certified Taxable Value

Taxing Authority	Millage Rate	Market	Assessed	Exempt	Taxable
Leon County	8.31440	\$80,000	\$72,600	\$0	\$72,600
Leon County - Emergency Medical Service	0.75000	\$80,000	\$72,600	\$0	\$72,600
Children Services Council	0.34770	\$80,000	\$72,600	\$0	\$72,600
School - State Law	3.13600	\$80,000	\$80,000	\$0	\$80,000
School - Local Board	2.24800	\$80,000	\$80,000	\$0	\$80,000
NW FL Water Management	0.02180	\$80,000	\$72,600	\$0	\$72,600

Building

Building Use	Building Type	Year Built	Heated/Cooled SqFt	Auxiliary SqFt

Characteristics

Measurements

Area	Description	SqFt

Sketch

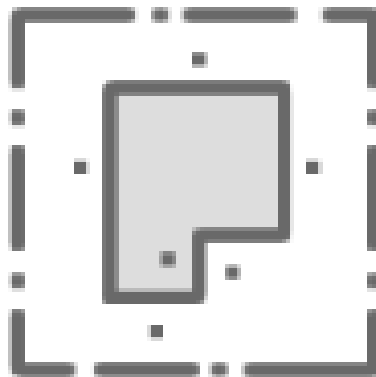

Sorry, no sketch available
for this record