



Leon County Property Appraiser - Parcel Details

Printed on: 11/24/2024

The Tax Roll is compiled by Legal Descriptions recorded in the Public Records of Leon County. Location addresses are not used in the preparation of the Tax Roll. They should not be used for title searches or preparation of legal documents.

Parcel Summary

Parcel Number 2124205010000	Location 226 BRADFORD RD UNIT 1
Owner(s) OLIVER JAMES RESIDENTIAL LLC	Property Use 0000 - VACANT RESIDENTIAL
Mailing Address 1168 NW 120TH WAY GAINESVILLE FL 32606	Legal SECTION 24 T1N R1W OR 4935/1917 (AND ALSO DESC)
Subdivision UNPLATTED LAND	Tax District 1 - CITY
Acreage 0.4300	Parent Parcel 2124204080000

Sales Information

Sale Date	Sale Price	Book/Page	Instrument Type	Improved/Vacant
6/30/2023	\$484,900	5864/1195	Warranty Deed	Vacant
6/30/2023	\$100	5863/1115	Warranty Deed	Vacant
4/21/2022	\$0	5726/950	Affidavit	Improved

Homestead Information

Tax Year	Status	Details
2025	No	
2024	No	

Certified Value History

Tax Year	Land	Building	Total Market	Homestead Savings	Classified Use
2024	\$60,000	\$0	\$60,000	\$0	\$0
2023	\$55,000	\$0	\$55,000	\$0	\$0

2024 Certified Taxable Value

Taxing Authority	Millage Rate	Market	Assessed	Exempt	Taxable
Leon County	8.31440	\$60,000	\$60,000	\$0	\$60,000
Leon County - Emergency Medical Service	0.75000	\$60,000	\$60,000	\$0	\$60,000
Children Services Council	0.34770	\$60,000	\$60,000	\$0	\$60,000
School - State Law	3.13600	\$60,000	\$60,000	\$0	\$60,000
School - Local Board	2.24800	\$60,000	\$60,000	\$0	\$60,000
City of Tallahassee	4.42000	\$60,000	\$60,000	\$0	\$60,000
NW FL Water Management	0.02180	\$60,000	\$60,000	\$0	\$60,000

Building

Building Use	Building Type	Year Built	Heated/Cooled SqFt	Auxiliary SqFt

Characteristics

Measurements

Area	Description	SqFt

Sketch

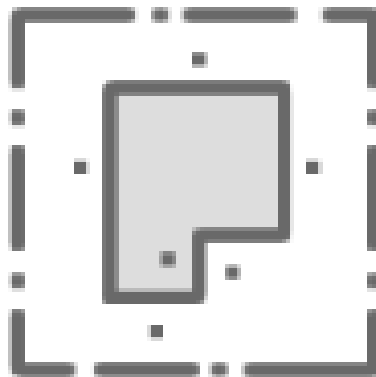

Sorry, no sketch available
for this record