



Leon County Property Appraiser - Parcel Details

Printed on: 10/22/2024

Parcel Summary

Parcel Number 2132204490000	Location 4003 W PENSACOLA ST
Owner(s) PARKER ROOFING OPTIONS LLC	Property Use 0000 - VACANT RESIDENTIAL
Mailing Address PO BOX 180026 TALLAHASSEE FL 32303	Legal SECTION 32 T1N R1W OR 2966/1371 DB 89/401 OR 180/160 431/114
Subdivision UNPLATTED LAND	Tax District 2 - COUNTY
Acreage 0.8900	Parent Parcel

Sales Information

Sales Date	Sales Price	Book/Page	Instrument Type	Improved/Vacant
9/30/2024	\$885,000	5992/1322	Estate Deed	Vacant
12/18/2020	\$0	5541/1398	Probate	Vacant
10/1/2003	\$100	2966/1371	Quit Claim	Vacant

Homestead Information

Tax Year	Status	Details
2025	No	
2024	No	

Certified Value History

Tax Year	Land	Building	Total Market	Homestead Savings	Classified Use
2024	\$40,000	\$0	\$40,000	\$0	\$0
2023	\$30,000	\$0	\$30,000	\$0	\$0
2022	\$24,000	\$0	\$24,000	\$0	\$0

Certified Taxable Value

Taxing Authority	Milage Rate	Market	Assessed	Exempt	Taxable
Leon County	8.31440	\$40,000	\$26,620	\$0	\$26,620
Leon County - Emergency Medical Service	0.75000	\$40,000	\$26,620	\$0	\$26,620
Children Services Council	0.34770	\$40,000	\$26,620	\$0	\$26,620
School - State Law	3.13600	\$40,000	\$40,000	\$0	\$40,000
School - Local Board	2.24800	\$40,000	\$40,000	\$0	\$40,000
NW FL Water Management	0.02180	\$40,000	\$26,620	\$0	\$26,620

Building

Building Use	Building Type	Year Built	Heated/Cooled SqFt	Auxiliary SqFt

Characteristics

Measurements

Area	Description	SqFT

Sketch

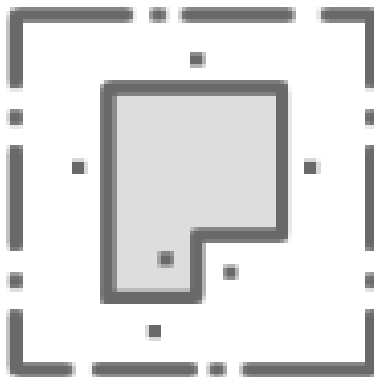

Sorry, no sketch available
for this record