



Leon County Property Appraiser - Parcel Details

Printed on: 11/23/2024

The Tax Roll is compiled by Legal Descriptions recorded in the Public Records of Leon County. Location addresses are not used in the preparation of the Tax Roll. They should not be used for title searches or preparation of legal documents.

Parcel Summary

Parcel Number 2132204500000	Location 0 W PENSACOLA ST
Owner(s) PARKER ROOFING OPTIONS LLC	Property Use 1000 - VACANT COMMERCIAL
Mailing Address PO BOX 180026 TALLAHASSEE FL 32303	Legal 32 1N 1W .02 IN SE 1/4 DB 89/401 OR 412/191 724/682
Subdivision UNPLATTED LAND	Tax District 2 - COUNTY
Acreage 0.0300	Parent Parcel

Sales Information

Sale Date	Sale Price	Book/Page	Instrument Type	Improved/Vacant
9/30/2024	\$885,000	5992/1322	Estate Deed	Vacant
12/18/2020	\$0	5541/1398	Probate	Vacant

Homestead Information

Tax Year	Status	Details
2025	No	
2024	No	

Certified Value History

Tax Year	Land	Building	Total Market	Homestead Savings	Classified Use
2024	\$300	\$0	\$300	\$0	\$0
2023	\$294	\$0	\$294	\$0	\$0
2022	\$294	\$0	\$294	\$0	\$0

2024 Certified Taxable Value

Taxing Authority	Millage Rate	Market	Assessed	Exempt	Taxable
Leon County	8.31440	\$300	\$300	\$0	\$300
Leon County - Emergency Medical Service	0.75000	\$300	\$300	\$0	\$300
Children Services Council	0.34770	\$300	\$300	\$0	\$300
School - State Law	3.13600	\$300	\$300	\$0	\$300
School - Local Board	2.24800	\$300	\$300	\$0	\$300
NW FL Water Management	0.02180	\$300	\$300	\$0	\$300

Building

Building Use	Building Type	Year Built	Heated/Cooled SqFt	Auxiliary SqFt

Characteristics

Measurements

Area	Description	SqFt

Sketch

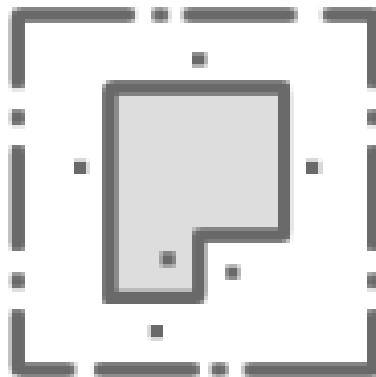

Sorry, no sketch available
for this record