



# Leon County Property Appraiser - Parcel Details

Printed on: 11/23/2024

The Tax Roll is compiled by Legal Descriptions recorded in the Public Records of Leon County. Location addresses are not used in the preparation of the Tax Roll. They should not be used for title searches or preparation of legal documents.

## Parcel Summary

Parcel Number 2424200440000	Location 0 GARDNER RD
Owner(s) AYAVALLA LAND COMPANY LLC	Property Use 0000 - VACANT RESIDENTIAL
Mailing Address 2627 MITCHAM DR TALLAHASSEE FL 32308-5404	Legal SECTION 24 T2N R1W OR 5969/645
Subdivision UNPLATTED LAND	Tax District 2 - COUNTY
Acreage 1.0000	Parent Parcel

## Sales Information

Sale Date	Sale Price	Book/Page	Instrument Type	Improved/Vacant
7/11/2024	\$30,000	5969/645	Warranty Deed	Vacant
12/21/2021	\$25,000	5686/668	Warranty Deed	Vacant
4/16/2010	\$25,000	4108/228	Deed In Lieu Of Foreclosure	Vacant

## Homestead Information

Tax Year	Status	Details
2025	No	
2024	No	

## Certified Value History

Tax Year	Land	Building	Total Market	Homestead Savings	Classified Use
2024	\$17,500	\$0	\$17,500	\$0	\$0
2023	\$17,500	\$0	\$17,500	\$0	\$0
2022	\$17,500	\$0	\$17,500	\$0	\$0

## 2024 Certified Taxable Value

Taxing Authority	Millage Rate	Market	Assessed	Exempt	Taxable
Leon County	8.31440	\$17,500	\$17,500	\$0	\$17,500
Leon County - Emergency Medical Service	0.75000	\$17,500	\$17,500	\$0	\$17,500
Children Services Council	0.34770	\$17,500	\$17,500	\$0	\$17,500
School - State Law	3.13600	\$17,500	\$17,500	\$0	\$17,500
School - Local Board	2.24800	\$17,500	\$17,500	\$0	\$17,500
NW FL Water Management	0.02180	\$17,500	\$17,500	\$0	\$17,500

## Building

Building Use	Building Type	Year Built	Heated/Cooled SqFt	Auxiliary SqFt

### Characteristics

### Measurements

Area	Description	SqFt

## Sketch

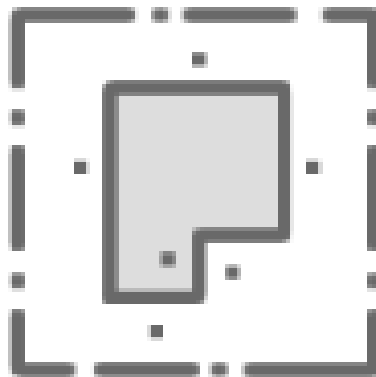

Sorry, no sketch available  
for this record