



# Leon County Property Appraiser - Parcel Details

Printed on: 02/12/2025

The Tax Roll is compiled by Legal Descriptions recorded in the Public Records of Leon County. Location addresses are not used in the preparation of the Tax Roll. They should not be used for title searches or preparation of legal documents.

## Parcel Summary

Parcel Number 2625206140000	Location 0 EARLS SLOUGH CT
Owner(s) TRAFTON MARK V AMOS MALLORY CAROL	Property Use 0000 - VACANT RESIDENTIAL
Mailing Address 659 EARLS SLOUGH CT TALLAHASSEE FL 32312-0903	Legal 25 3N 1W .881 A AKA LAKE IAMONIA PROP UNREC LOT 10 IN NE 1/4 OF SW 1/4 OR 2161/1040 2270/1078 2312/475
Subdivision UNPLATTED LAND	Tax District 2 - COUNTY
Acreage 0.8810	Parent Parcel 2625206100000

## Sales Information

Sale Date	Sale Price	Book/Page	Instrument Type	Improved/Vacant
12/4/2024	\$454,000	6011/2197	Warranty Deed	Vacant
6/4/2021	\$376,000	5597/1839	Warranty Deed	Vacant
9/17/2017	\$0	5163/1921	Probate	Vacant

## Homestead Information

Tax Year	Status	Details
2025	No	
2024	No	

## Certified Value History

Tax Year	Land	Building	Total Market	Homestead Savings	Classified Use
2024	\$22,025	\$0	\$22,025	\$0	\$0
2023	\$19,382	\$0	\$19,382	\$0	\$0
2022	\$17,620	\$0	\$17,620	\$0	\$0

## 2024 Certified Taxable Value

Taxing Authority	Millage Rate	Market	Assessed	Exempt	Taxable
Leon County	8.31440	\$22,025	\$21,320	\$0	\$21,320
Leon County - Emergency Medical Service	0.75000	\$22,025	\$21,320	\$0	\$21,320
Children Services Council	0.34770	\$22,025	\$21,320	\$0	\$21,320
School - State Law	3.13600	\$22,025	\$22,025	\$0	\$22,025
School - Local Board	2.24800	\$22,025	\$22,025	\$0	\$22,025
NW FL Water Management	0.02180	\$22,025	\$21,320	\$0	\$21,320

## Building

Building Use	Building Type	Year Built	Heated/Cooled SqFt	Auxiliary SqFt

### Characteristics

### Measurements

Area	Description	SqFt

## Sketch

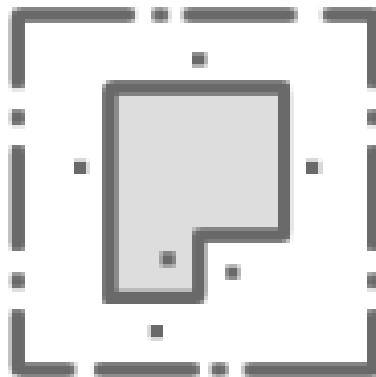

Sorry, no sketch available  
for this record