



## Leon County Property Appraiser - Parcel Details

The Tax Roll is compiled by Legal Descriptions recorded in the Public Records of Leon County. Location addresses are not used in the preparation of the Tax Roll. They should not be used for title searches or preparation of legal documents.

### Parcel Summary

Parcel Number 3109202350000	Location MONDAY RD
Owner(s) REED G	Property Use 0000 - VACANT RESIDENTIAL
Mailing Address PO BOX 356 CHIPLEY FL 32428	Legal 9 1S 1E 1 A IN NW 1/4 DB 252/429 91-495PR 1860/1732
Subdivision UNPLATTED LAND	Tax District 1 - CITY
Acreage 1.0000	Parent Parcel

### Sales Information

Sale Date	Sale Price	Book/Page	Instrument Type	Improved/Vacant
8/21/2024	\$12,500	5981/995	Tax Deed	Vacant
7/8/2003	\$8,400	2906/324	Quit Claim	Vacant
1/18/2001	\$2,500	2586/1139	Quit Claim	Vacant

### Homestead Information

Tax Year	Status	Details
2025	No	
2024	No	

### Certified Value History

Tax Year	Land	Building	Total Market	Homestead Savings	Classified Use
2024	\$15,000	\$0	\$15,000	\$0	\$0
2023	\$15,000	\$0	\$15,000	\$0	\$0
2022	\$15,000	\$0	\$15,000	\$0	\$0

### 2024 Certified Taxable Value

Taxing Authority	Millage Rate	Market	Assessed	Exempt	Taxable
Leon County	8.31440	\$15,000	\$15,000	\$0	\$15,000
Leon County - Emergency Medical Service	0.75000	\$15,000	\$15,000	\$0	\$15,000
Children Services Council	0.34770	\$15,000	\$15,000	\$0	\$15,000
School - State Law	3.13600	\$15,000	\$15,000	\$0	\$15,000
School - Local Board	2.24800	\$15,000	\$15,000	\$0	\$15,000
City of Tallahassee	4.42000	\$15,000	\$15,000	\$0	\$15,000
NW FL Water Management	0.02180	\$15,000	\$15,000	\$0	\$15,000

## Building

Building Use	Building Type	Year Built	Heated/Cooled SqFt	Auxiliary SqFt

### Characteristics

### Measurements

Area	Description	SqFt

## Sketch

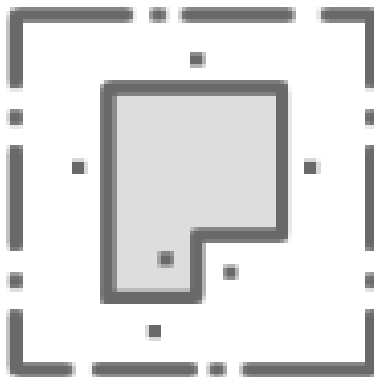

Sorry, no sketch available  
for this record