



Leon County Property Appraiser - Parcel Details

Printed on: 10/22/2024

Parcel Summary

Parcel Number 3119200020001	Location 0 TRAM CT
Owner(s) BENNERS BRAD S	Property Use 0000 - VACANT RESIDENTIAL
Mailing Address 3618 PEDDIE DR TALLAHASSEE FL 32303-1126	Legal 19 1S 1E 7 A IN NE 1/4 OF NE 1/4 OR 1203/792 2680/2172
Subdivision UNPLATTED LAND	Tax District 2 - COUNTY
Acreage 7.0000	Parent Parcel 3119200020000

Sales Information

Sales Date	Sales Price	Book/Page	Instrument Type	Improved/Vacant
10/1/2024	\$95,000	5994/500	Warranty Deed	Vacant
10/1/2024	\$100	5994/497	Quit Claim	Vacant
12/12/2013	\$8,200	4611/464	Tax Deed	Vacant

Homestead Information

Tax Year	Status	Details
2025	No	
2024	No	

Certified Value History

Tax Year	Land	Building	Total Market	Homestead Savings	Classified Use
2024	\$24,500	\$0	\$24,500	\$0	\$0
2023	\$24,500	\$0	\$24,500	\$0	\$0
2022	\$24,500	\$0	\$24,500	\$0	\$0

Certified Taxable Value

Taxing Authority	Milage Rate	Market	Assessed	Exempt	Taxable
Leon County	8.31440	\$24,500	\$24,500	\$0	\$24,500
Leon County - Emergency Medical Service	0.75000	\$24,500	\$24,500	\$0	\$24,500
Children Services Council	0.34770	\$24,500	\$24,500	\$0	\$24,500
School - State Law	3.13600	\$24,500	\$24,500	\$0	\$24,500
School - Local Board	2.24800	\$24,500	\$24,500	\$0	\$24,500
NW FL Water Management	0.02180	\$24,500	\$24,500	\$0	\$24,500

Building

Building Use	Building Type	Year Built	Heated/Cooled SqFt	Auxiliary SqFt

Characteristics

Measurements

Area	Description	SqFT

Sketch

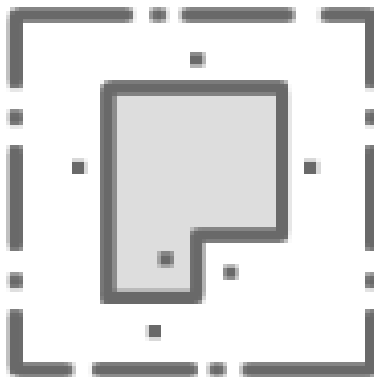

Sorry, no sketch available
for this record