



Leon County Property Appraiser - Parcel Details

Printed on: 11/23/2024

The Tax Roll is compiled by Legal Descriptions recorded in the Public Records of Leon County. Location addresses are not used in the preparation of the Tax Roll. They should not be used for title searches or preparation of legal documents.

Parcel Summary

Parcel Number 3214202040010	Location W W KELLEY RD
Owner(s) SKYLINE BUILDING AND INVESTMENTS INC	Property Use 6000 - GRAZING, CLASS I
Mailing Address 1342 TIMBERLANE RD STE 102-A TALLAHASSEE FL 32312	Legal SECTION 15 T1S R2E LOT 1 LIMITED PARTITION OR 5990/2272 OR 5972/1984 OR 53/366 1323/2063 1572/1238 1640/670
Subdivision UNPLATTED LAND	Tax District 2 - COUNTY
Acreage 5.1600	Parent Parcel 321420204000Z

Sales Information

Sale Date	Sale Price	Book/Page	Instrument Type	Improved/Vacant
9/23/2024	\$0	5990/2272	Affidavit	Improved
7/23/2024	\$450,000	5972/1984	Warranty Deed	Improved
2/16/2024	\$0	5926/403	Affidavit	Improved

Homestead Information

Tax Year	Status	Details
2025	No	
2024	No	

Certified Value History

Tax Year	Land	Building	Total Market	Homestead Savings	Classified Use
2024	\$21,672	\$0	\$21,672	\$0	\$1,806

2024 Certified Taxable Value

Taxing Authority	Millage Rate	Market	Assessed	Exempt	Taxable
Leon County	8.31440	\$21,672	\$1,806	\$0	\$1,806
Leon County - Emergency Medical Service	0.75000	\$21,672	\$1,806	\$0	\$1,806
Children Services Council	0.34770	\$21,672	\$1,806	\$0	\$1,806
School - State Law	3.13600	\$21,672	\$1,806	\$0	\$1,806
School - Local Board	2.24800	\$21,672	\$1,806	\$0	\$1,806
NW FL Water Management	0.02180	\$21,672	\$1,806	\$0	\$1,806

Building

Building Use	Building Type	Year Built	Heated/Cooled SqFt	Auxiliary SqFt

Characteristics

Measurements

Area	Description	SqFt

Sketch

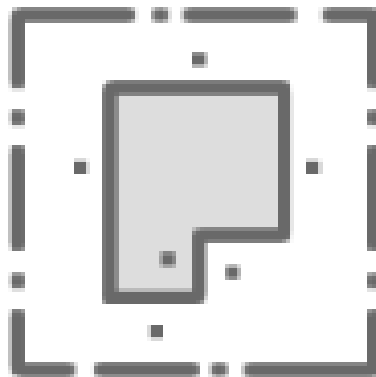

Sorry, no sketch available
for this record