



Leon County Property Appraiser - Parcel Details

Printed on: 10/22/2024

Parcel Summary

Parcel Number 3214202040040	Location W W KELLEY RD
Owner(s) SKYLINE BUILDING AND INVESTMENTS INC	Property Use 6000 - GRAZING, CLASS I
Mailing Address 1342 TIMBERLANE RD STE 102-A TALLAHASSEE FL 32312	Legal SECTION 15 T1S R2E LOT 4 LIMITED PARTITION OR 5990/2272 OR 5972/1984 OR 53/366 1323/2063 1572/1238 1640/670
Subdivision UNPLATTED LAND	Tax District 2 - COUNTY
Acreage 5.6400	Parent Parcel 321420204000Z

Sales Information

Sales Date	Sales Price	Book/Page	Instrument Type	Improved/Vacant
9/23/2024	\$0	5990/2272	Affidavit	Vacant
7/23/2024	\$450,000	5972/1984	Warranty Deed	Improved
10/18/2007	\$100	3781/1023	Quit Claim	Improved

Homestead Information

Tax Year	Status	Details
2025	No	
2024	No	

Certified Value History

Tax Year	Land	Building	Total Market	Homestead Savings	Classified Use
2024	\$23,688	\$0	\$23,688	\$0	\$1,974

Certified Taxable Value

Taxing Authority	Milage Rate	Market	Assessed	Exempt	Taxable
Leon County	8.31440	\$23,688	\$1,974	\$0	\$1,974
Leon County - Emergency Medical Service	0.75000	\$23,688	\$1,974	\$0	\$1,974
Children Services Council	0.34770	\$23,688	\$1,974	\$0	\$1,974
School - State Law	3.13600	\$23,688	\$1,974	\$0	\$1,974
School - Local Board	2.24800	\$23,688	\$1,974	\$0	\$1,974
NW FL Water Management	0.02180	\$23,688	\$1,974	\$0	\$1,974

Building

Building Use	Building Type	Year Built	Heated/Cooled SqFt	Auxiliary SqFt

Characteristics

Measurements

Area	Description	SqFT

Sketch

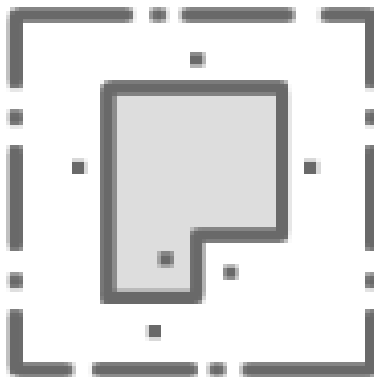

Sorry, no sketch available
for this record