



Leon County Property Appraiser - Parcel Details

Printed on: 10/22/2024

Parcel Summary

Parcel Number 3317206150000	Location 1030 SUNFLOWER RD
Owner(s) BUTLER BILLY F JR BUTLER DAISY M	Property Use 0000 - VACANT RESIDENTIAL
Mailing Address 1030 SUNFLOWER RD TALLAHASSEE FL 32305-9538	Legal 17 2S 1E 5 A IN NW 1/4 OF SW 1/4 OR 1372/455 1922/1796 1966/976
Subdivision UNPLATTED LAND	Tax District 2 - COUNTY
Acreage 5.0000	Parent Parcel

Sales Information

Sales Date	Sales Price	Book/Page	Instrument Type	Improved/Vacant
10/2/2024	\$434,000	5993/555	Warranty Deed	Vacant
7/27/2023	\$100	5871/29	Warranty Deed	Vacant
2/14/2020	\$70,000	5414/706	Warranty Deed	Vacant

Homestead Information

Tax Year	Status	Details
2025	No	
2024	No	

Certified Value History

Tax Year	Land	Building	Total Market	Homestead Savings	Classified Use
2024	\$33,750	\$0	\$33,750	\$0	\$0
2023	\$30,000	\$0	\$30,000	\$0	\$0
2022	\$30,000	\$0	\$30,000	\$0	\$0

Certified Taxable Value

Taxing Authority	Milage Rate	Market	Assessed	Exempt	Taxable
Leon County	8.31440	\$33,750	\$33,750	\$0	\$33,750
Leon County - Emergency Medical Service	0.75000	\$33,750	\$33,750	\$0	\$33,750
Children Services Council	0.34770	\$33,750	\$33,750	\$0	\$33,750
School - State Law	3.13600	\$33,750	\$33,750	\$0	\$33,750
School - Local Board	2.24800	\$33,750	\$33,750	\$0	\$33,750
NW FL Water Management	0.02180	\$33,750	\$33,750	\$0	\$33,750

Building

Building Use	Building Type	Year Built	Heated/Cooled SqFt	Auxiliary SqFt

Characteristics

Measurements

Area	Description	SqFT

Sketch

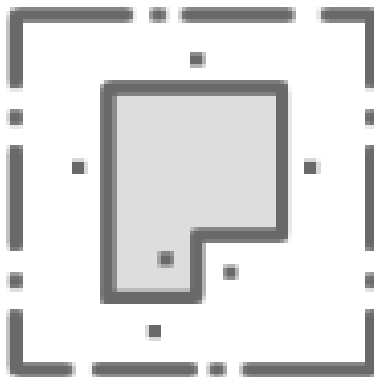

Sorry, no sketch available
for this record