



Leon County Property Appraiser - Parcel Details

Printed on: 11/24/2024

The Tax Roll is compiled by Legal Descriptions recorded in the Public Records of Leon County. Location addresses are not used in the preparation of the Tax Roll. They should not be used for title searches or preparation of legal documents.

Parcel Summary

Parcel Number 3322200020000	Location 11207 REGISTER FARM RD
Owner(s) FRITZ DEREK FRITZ KAYLA	Property Use 5002 - IMPROVED TIMBER
Mailing Address 11207 REGISTER FARM RD TALLAHASSEE FL 32305	Legal SECTION 22 T2S R1E LOT 1 ASAP OR 5914/2180 OR 5915/2115
Subdivision UNPLATTED LAND	Tax District 2 - COUNTY
Acreage 15.1100	Parent Parcel

Sales Information

Sale Date	Sale Price	Book/Page	Instrument Type	Improved/Vacant
5/2/2024	\$635,000	5951/332	Warranty Deed	Improved
12/22/2023	\$0	5914/2180	Affidavit	Vacant
6/15/2023	\$166,300	5860/295	Warranty Deed	Vacant

Homestead Information

Tax Year	Status	Details
2025	Yes	If no change in ownership occurs before Jan 1, 2025
2024	No	

Certified Value History

Tax Year	Land	Building	Total Market	Homestead Savings	Classified Use
2024	\$75,550	\$0	\$75,550	\$0	\$10,461
2023	\$151,150	\$0	\$151,150	\$0	\$9,613
2022	\$151,150	\$0	\$151,150	\$0	\$9,613

2024 Certified Taxable Value

Taxing Authority	Millage Rate	Market	Assessed	Exempt	Taxable
Leon County	8.31440	\$75,550	\$10,461	\$0	\$10,461
Leon County - Emergency Medical Service	0.75000	\$75,550	\$10,461	\$0	\$10,461
Children Services Council	0.34770	\$75,550	\$10,461	\$0	\$10,461
School - State Law	3.13600	\$75,550	\$10,461	\$0	\$10,461
School - Local Board	2.24800	\$75,550	\$10,461	\$0	\$10,461
NW FL Water Management	0.02180	\$75,550	\$10,461	\$0	\$10,461

Building

Building Use	Building Type	Year Built	Heated/Cooled SqFt	Auxiliary SqFt

Characteristics

Measurements

Area	Description	SqFt

Sketch

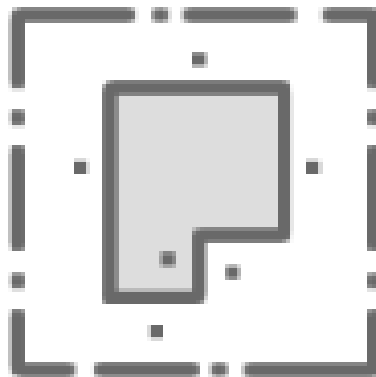

Sorry, no sketch available
for this record