



Leon County Property Appraiser - Parcel Details

Printed on: 11/24/2024

The Tax Roll is compiled by Legal Descriptions recorded in the Public Records of Leon County. Location addresses are not used in the preparation of the Tax Roll. They should not be used for title searches or preparation of legal documents.

Parcel Summary

Parcel Number 3412200500000	Location NATURAL BRIDGE RD
Owner(s) FLORIDA BOARD OF TRUSTEES OF INTERNAL	Property Use 8000 - VACANT GOVERNMENTAL
Mailing Address C/O FL DEPT OF ENVIRONMENTAL PROTECTION 3900 COMMONWEALTH BLVD MAIL STA 115 TALLAHASSEE FL 32399-3000	Legal SECTION 12 T2S R2E SOUTH PART OF SECTION OR 5913/1971
Subdivision UNPLATTED LAND	Tax District 2 - COUNTY
Acreage 326.0000	Parent Parcel 3411200500000

Sales Information

Sale Date	Sale Price	Book/Page	Instrument Type	Improved/Vacant
12/20/2023	\$13,400,000	5913/1971	Warranty Deed	Vacant
2/28/2022	\$8,200,000	5709/1683	Warranty Deed	Vacant

Homestead Information

Tax Year	Status	Details
2025	No	
2024	No	

Certified Value History

Tax Year	Land	Building	Total Market	Homestead Savings	Classified Use
2024	\$586,800	\$0	\$586,800	\$0	\$0
2023	\$586,800	\$0	\$586,800	\$0	\$44,937
2022	\$586,800	\$0	\$586,800	\$0	\$44,937

2024 Certified Taxable Value

Taxing Authority	Millage Rate	Market	Assessed	Exempt	Taxable
Leon County	8.31440	\$586,800	\$586,800	\$586,800	\$0
Leon County - Emergency Medical Service	0.75000	\$586,800	\$586,800	\$586,800	\$0
Children Services Council	0.34770	\$586,800	\$586,800	\$586,800	\$0
School - State Law	3.13600	\$586,800	\$586,800	\$586,800	\$0
School - Local Board	2.24800	\$586,800	\$586,800	\$586,800	\$0
NW FL Water Management	0.02180	\$586,800	\$586,800	\$586,800	\$0

Building

Building Use	Building Type	Year Built	Heated/Cooled SqFt	Auxiliary SqFt

Characteristics

Measurements

Area	Description	SqFt

Sketch

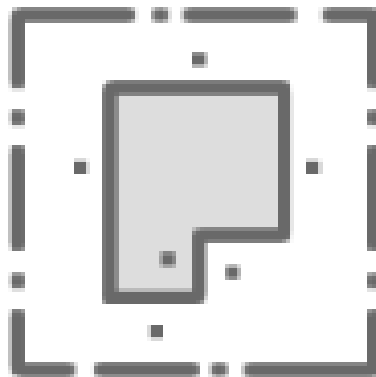

Sorry, no sketch available
for this record