



# Leon County Property Appraiser - Parcel Details

Printed on: 11/23/2024

The Tax Roll is compiled by Legal Descriptions recorded in the Public Records of Leon County. Location addresses are not used in the preparation of the Tax Roll. They should not be used for title searches or preparation of legal documents.

## Parcel Summary

Parcel Number 4113204670000	Location 213 HANNON MILL RD
Owner(s) D&N PROPERTY GROUP LLC	Property Use 0000 - VACANT RESIDENTIAL
Mailing Address 125 HANNON MILL RD TALLAHASSEE FL 32305	Legal 13 1S 1W IN SE 1/4 OF SE 1/4 OR 206/581 333/461 OR 4327/1282
Subdivision UNPLATTED LAND	Tax District 2 - COUNTY
Acreage 0.4200	Parent Parcel

## Sales Information

Sale Date	Sale Price	Book/Page	Instrument Type	Improved/Vacant
3/12/2024	\$0	5933/1915	Probate	Improved
2/23/2024	\$10,000	5927/2375	Estate Deed	Vacant
12/1/2021	\$0	5930/2383	Probate	Improved

## Homestead Information

Tax Year	Status	Details
2025	No	
2024	No	

## Certified Value History

Tax Year	Land	Building	Total Market	Homestead Savings	Classified Use
2024	\$27,000	\$0	\$27,000	\$0	\$0
2023	\$27,000	\$0	\$27,000	\$0	\$0
2022	\$24,300	\$36,293	\$60,593	\$0	\$0

## 2024 Certified Taxable Value

Taxing Authority	Millage Rate	Market	Assessed	Exempt	Taxable
Leon County	8.31440	\$27,000	\$25,610	\$0	\$25,610
Leon County - Emergency Medical Service	0.75000	\$27,000	\$25,610	\$0	\$25,610
Children Services Council	0.34770	\$27,000	\$25,610	\$0	\$25,610
School - State Law	3.13600	\$27,000	\$27,000	\$0	\$27,000
School - Local Board	2.24800	\$27,000	\$27,000	\$0	\$27,000
NW FL Water Management	0.02180	\$27,000	\$25,610	\$0	\$25,610

## Building

Building Use	Building Type	Year Built	Heated/Cooled SqFt	Auxiliary SqFt

### Characteristics

### Measurements

Area	Description	SqFt

## Sketch

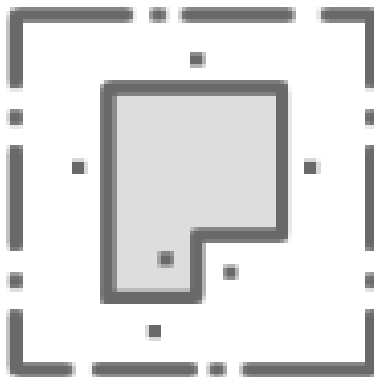

Sorry, no sketch available  
for this record