



# Leon County Property Appraiser - Parcel Details

Printed on: 11/14/2024

The Tax Roll is compiled by Legal Descriptions recorded in the Public Records of Leon County. Location addresses are not used in the preparation of the Tax Roll. They should not be used for title searches or preparation of legal documents.

## Parcel Summary

Parcel Number 4114207410000	Location ROBIN RD
Owner(s) BENINGNO DAVID REYNA	Property Use 0000 - VACANT RESIDENTIAL
Mailing Address 3619 ROBIN RD TALLAHASSEE FL 32305	Legal SECTION 14 T1S R1W BEING LOT 10 OR 5879/288
Subdivision UNPLATTED LAND	Tax District 2 - COUNTY
Acreage 0.3000	Parent Parcel

## Sales Information

Sale Date	Sale Price	Book/Page	Instrument Type	Improved/Vacant
8/23/2023	\$5,000	5879/288	Quit Claim	Improved
1/27/2022	\$0	5735/2246	Death Certificate	Improved
12/15/2021	\$100	5678/1124	Quit Claim	Improved

## Homestead Information

Tax Year	Status	Details
2025	No	
2024	No	

## Certified Value History

Tax Year	Land	Building	Total Market	Homestead Savings	Classified Use
2024	\$9,000	\$0	\$9,000	\$0	\$0
2023	\$6,000	\$0	\$6,000	\$0	\$0

## 2024 Certified Taxable Value

Taxing Authority	Millage Rate	Market	Assessed	Exempt	Taxable
Leon County	8.31440	\$9,000	\$9,000	\$0	\$9,000
Leon County - Emergency Medical Service	0.75000	\$9,000	\$9,000	\$0	\$9,000
Children Services Council	0.34770	\$9,000	\$9,000	\$0	\$9,000
School - State Law	3.13600	\$9,000	\$9,000	\$0	\$9,000
School - Local Board	2.24800	\$9,000	\$9,000	\$0	\$9,000
NW FL Water Management	0.02180	\$9,000	\$9,000	\$0	\$9,000

## Building

Building Use	Building Type	Year Built	Heated/Cooled SqFt	Auxiliary SqFt

### Characteristics

### Measurements

Area	Description	SqFt

## Sketch

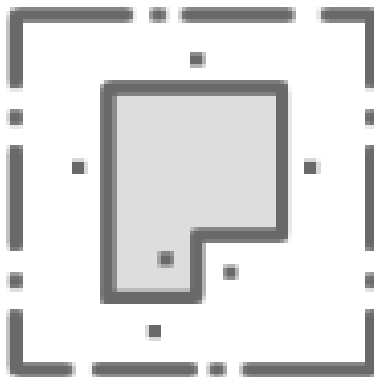

Sorry, no sketch available  
for this record