



## Leon County Property Appraiser - Parcel Details

The Tax Roll is compiled by Legal Descriptions recorded in the Public Records of Leon County. Location addresses are not used in the preparation of the Tax Roll. They should not be used for title searches or preparation of legal documents.

Parcel Summary	
Parcel Number 4114207980000	Location 0 ESTATES RD
Owner(s) LIGHT OF THE WORLD INTERNATIONAL INC	Property Use 0000 - VACANT RESIDENTIAL
Mailing Address 1543 CROWN RIDGE RD TALLAHASSEE FL 32305-6987	Legal 14 1S 1W IN SE 1/4 OF SW 1/4 OR 423/118 904/770 OR 1170/764
Subdivision UNPLATTED LAND	Tax District 2 - COUNTY
Acreage 0.3000	Parent Parcel

### Sales Information

Sale Date	Sale Price	Book/Page	Instrument Type	Improved/Vacant
9/11/2024	\$42,000	5987/1591	Warranty Deed	Vacant
8/7/2009	\$100	4018/744	Quit Claim	Vacant
9/17/2003	\$100	2991/560	Quit Claim	Vacant

### Homestead Information

Tax Year	Status	Details
2025	No	
2024	No	

### Certified Value History

Tax Year	Land	Building	Total Market	Homestead Savings	Classified Use
2024	\$12,000	\$0	\$12,000	\$0	\$0
2023	\$12,000	\$0	\$12,000	\$0	\$0
2022	\$12,000	\$0	\$12,000	\$0	\$0

### 2024 Certified Taxable Value

Taxing Authority	Millage Rate	Market	Assessed	Exempt	Taxable
Leon County	8.31440	\$12,000	\$12,000	\$0	\$12,000
Leon County - Emergency Medical Service	0.75000	\$12,000	\$12,000	\$0	\$12,000
Children Services Council	0.34770	\$12,000	\$12,000	\$0	\$12,000
School - State Law	3.13600	\$12,000	\$12,000	\$0	\$12,000
School - Local Board	2.24800	\$12,000	\$12,000	\$0	\$12,000
NW FL Water Management	0.02180	\$12,000	\$12,000	\$0	\$12,000

## Building

Building Use	Building Type	Year Built	Heated/Cooled SqFt	Auxiliary SqFt

### Characteristics

### Measurements

Area	Description	SqFt

## Sketch

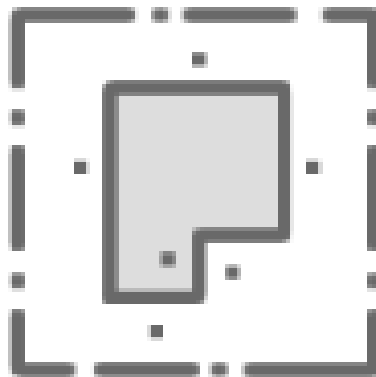

Sorry, no sketch available  
for this record