



Leon County Property Appraiser - Parcel Details

Printed on: 11/23/2024

The Tax Roll is compiled by Legal Descriptions recorded in the Public Records of Leon County. Location addresses are not used in the preparation of the Tax Roll. They should not be used for title searches or preparation of legal documents.

Parcel Summary

Parcel Number 4124202930000	Location 501 STRAW LN
Owner(s) TANISH VENTURES LLC	Property Use 0000 - VACANT RESIDENTIAL
Mailing Address 3255 BELLE MEADE TRL TALLAHASSEE FL 32311-3728	Legal 24 1S 1W IN SE 1/4 OF NW 1/4 OR 903/1130 1387/1107 1110 OR 1454/1796 2142/259
Subdivision UNPLATTED LAND	Tax District 2 - COUNTY
Acreage 0.7020	Parent Parcel

Sales Information

Sale Date	Sale Price	Book/Page	Instrument Type	Improved/Vacant
10/17/2024	\$60,500	5997/707	Tax Deed	Vacant
6/26/1998	\$100	2142/259	Warranty Deed	Vacant
8/3/1989	\$176,100	1454/1796	Estate Deed	Vacant

Homestead Information

Tax Year	Status	Details
2025	No	
2024	No	

Certified Value History

Tax Year	Land	Building	Total Market	Homestead Savings	Classified Use
2024	\$30,000	\$0	\$30,000	\$0	\$0
2023	\$30,000	\$0	\$30,000	\$0	\$0
2022	\$27,000	\$0	\$27,000	\$0	\$0

2024 Certified Taxable Value

Taxing Authority	Millage Rate	Market	Assessed	Exempt	Taxable
Leon County	8.31440	\$30,000	\$29,948	\$0	\$29,948
Leon County - Emergency Medical Service	0.75000	\$30,000	\$29,948	\$0	\$29,948
Children Services Council	0.34770	\$30,000	\$29,948	\$0	\$29,948
School - State Law	3.13600	\$30,000	\$30,000	\$0	\$30,000
School - Local Board	2.24800	\$30,000	\$30,000	\$0	\$30,000
NW FL Water Management	0.02180	\$30,000	\$29,948	\$0	\$29,948

Building

Building Use	Building Type	Year Built	Heated/Cooled SqFt	Auxiliary SqFt

Characteristics

Measurements

Area	Description	SqFt

Sketch

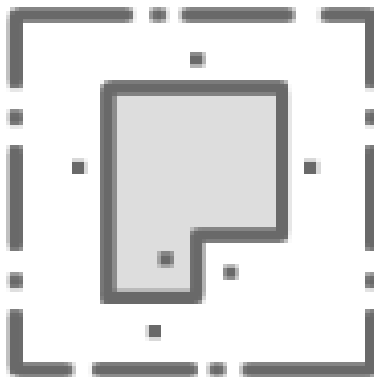

Sorry, no sketch available
for this record