



Leon County Property Appraiser - Parcel Details

Printed on: 11/27/2025

Disclaimer: The parcel description is a reference to descriptions recorded in the official records of the Leon County Clerk of Court. Neither parcel descriptions nor location addresses should be used in the preparation of deeds or other property conveyances.

Parcel Summary

Parcel Number 4125202020000	Location 5012 CRAWFORDVILLE RD
Owner(s) CIRCLE K STORES INC	Property Use 1000 - VACANT COMMERCIAL
Mailing Address C/O BRIAN LEACH/ACCOUNTING SUPERVISOR PO BOX 52085 DC-59 PHOENIX AZ 85072	Parcel Description SECTION 25 T1S R1W OR 2268/1415 LESS ROW TAKING OR 5803/987 OR 1479/1509
Subdivision UNPLATTED LAND	Tax District 1 - CITY
Acreage 1.5600	Parent Parcel

Sales Information

Sale Date	Sale Price	Book/Page	Instrument Type	Improved/Vacant
11/15/2003	\$0	4471/127	Corporate Merger	Improved
6/18/1999	\$1,035,500	2268/1415	Warranty Deed	Improved
3/23/1977	\$70,000	0848/0490	Warranty Deed	Vacant

Homestead Information

Tax Year	Status	Details
2026	No	
2025	No	

Certified Value History

Tax Year	Land	Building	Total Market	Homestead Savings	Classified Use
2025	\$201,314	\$0	\$201,314	\$0	\$0
2024	\$196,217	\$769,052	\$965,269	\$0	\$0
2023	\$191,121	\$733,439	\$924,560	\$0	\$0

2025 Certified Taxable Value

Taxing Authority	Millage Rate	Market	Assessed	Exempt	Taxable
Leon County	8.31440	\$201,314	\$201,314	\$0	\$201,314
Leon County - Emergency Medical Service	0.75000	\$201,314	\$201,314	\$0	\$201,314
Children Services Council	0.34770	\$201,314	\$201,314	\$0	\$201,314
School - State Law	3.11800	\$201,314	\$201,314	\$0	\$201,314
School - Local Board	2.24800	\$201,314	\$201,314	\$0	\$201,314
City of Tallahassee	4.40720	\$201,314	\$201,314	\$0	\$201,314
NW FL Water Management	0.02070	\$201,314	\$201,314	\$0	\$201,314

Building

Building Use	Building Type	Year Built	Heated/Cooled SqFt	Auxiliary SqFt

Characteristics

Measurements

Area	Description	SqFt

Sketch

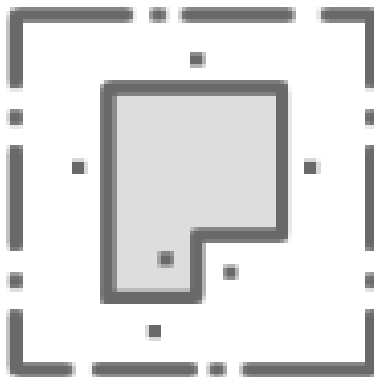

Sorry, no sketch available
for this record