



# Leon County Property Appraiser - Parcel Details

Printed on: 11/14/2024

The Tax Roll is compiled by Legal Descriptions recorded in the Public Records of Leon County. Location addresses are not used in the preparation of the Tax Roll. They should not be used for title searches or preparation of legal documents.

## Parcel Summary

|  |   |
|--|---|
| Parcel Number<br>4413200150010                               | Location<br>0 BLUE LAKE RUN   |
| Owner(s)<br>DENNIS KACY<br>DENNIS ROLANDA                    | Property Use<br>0000 - VACANT RESIDENTIAL   |
| Mailing Address<br>8379 GLENDALIN RD<br>TALLAHASSEE FL 32311 | Legal<br>SECTION 13 T1S R4W<br>LOTS 1 THRU 6 219 SUBDIVISION OR 2002/1729<br>OR 5616/1920 |
| Subdivision<br>UNPLATTED LAND                                | Tax District<br>2 - COUNTY  |
| Acreage<br>5.3700  | Parent Parcel<br>4413200150000  |

## Sales Information

| Sale Date | Sale Price | Book/Page | Instrument Type | Improved/Vacant |
|-----------|------------|-----------|-----------------|-----------------|
| 5/6/2024  | \$125,000  | 5950/233  | Warranty Deed   | Vacant          |
| 7/21/2021 | \$100,000  | 5616/1920 | Warranty Deed   | Vacant          |
| 4/7/2009  | \$75,000   | 3971/935  | Warranty Deed   | Vacant          |

## Homestead Information

| Tax Year | Status | Details |
|----------|--------|---------|
| 2025     | No     |         |
| 2024     | No     |         |

## Certified Value History

| Tax Year | Land     | Building | Total Market | Homestead Savings | Classified Use |
|----------|----------|----------|--------------|-------------------|----------------|
| 2024     | \$48,330 | \$0      | \$48,330     | \$0               | \$0            |
| 2023     | \$42,960 | \$0      | \$42,960     | \$0               | \$0            |
| 2022     | \$42,960 | \$0      | \$42,960     | \$0               | \$0            |

## 2024 Certified Taxable Value

| Taxing Authority                        | Millage Rate | Market   | Assessed | Exempt | Taxable  |
|---|--------------|----------|----------|--------|----------|
| Leon County                             | 8.31440      | \$48,330 | \$47,256 | \$0    | \$47,256 |
| Leon County - Emergency Medical Service | 0.75000      | \$48,330 | \$47,256 | \$0    | \$47,256 |
| Children Services Council               | 0.34770      | \$48,330 | \$47,256 | \$0    | \$47,256 |
| School - State Law                      | 3.13600      | \$48,330 | \$48,330 | \$0    | \$48,330 |
| School - Local Board                    | 2.24800      | \$48,330 | \$48,330 | \$0    | \$48,330 |
| NW FL Water Management                  | 0.02180      | \$48,330 | \$47,256 | \$0    | \$47,256 |
|   |              |          |          |        |          |
|   |              |          |          |        |          |

## Building

| Building Use | Building Type | Year Built | Heated/Cooled SqFt | Auxiliary SqFt |
|--------------|---------------|------------|--------------------|----------------|
|              |               |            |                    |                |

### Characteristics

|  |  |
|--|--|
|  |  |
|  |  |
|  |  |
|  |  |
|  |  |
|  |  |
|  |  |
|  |  |

### Measurements

| Area | Description | SqFt |
|------|-------------|------|
|      |             |      |
|      |             |      |
|      |             |      |
|      |             |      |
|      |             |      |

## Sketch

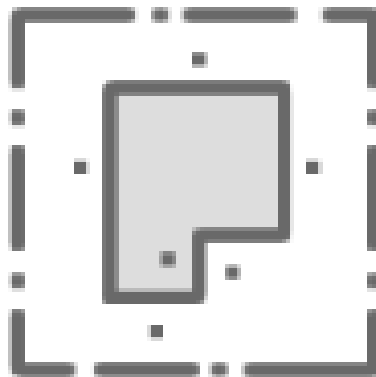

Sorry, no sketch available  
for this record